

OASIS2900

Patio Insect Shades



Retractable Insect Screens and patio shades for patios, doors, garages, windows and patio enclosure applications

- Custom sizes to 19' wide
- Motorized operation with Somfy or Driven by Lutron™ systems
- SHY® Zip zipper-retention side track system
- 4-sided seal keeps bugs OUT, with weather stripping at head box and hem bar



Oasis 2900 Head Box

5" x 5 1/2" Aluminum Head Box

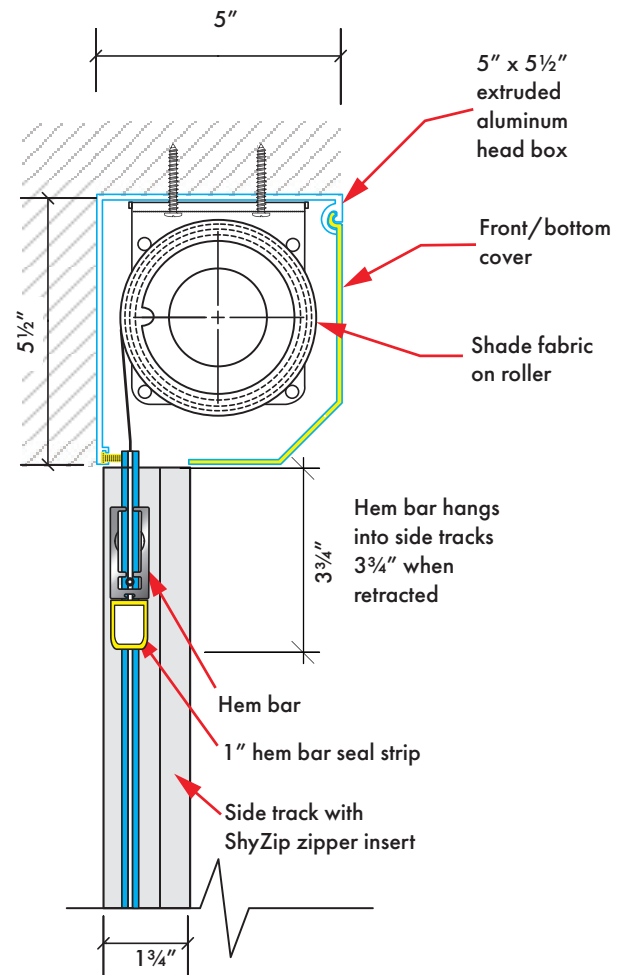

- Integrated with structure
- Easy access to shade by removing front/bottom cover
- Wall or ceiling mount
- Aluminum end caps
- Heavy-duty aluminum mounting brackets

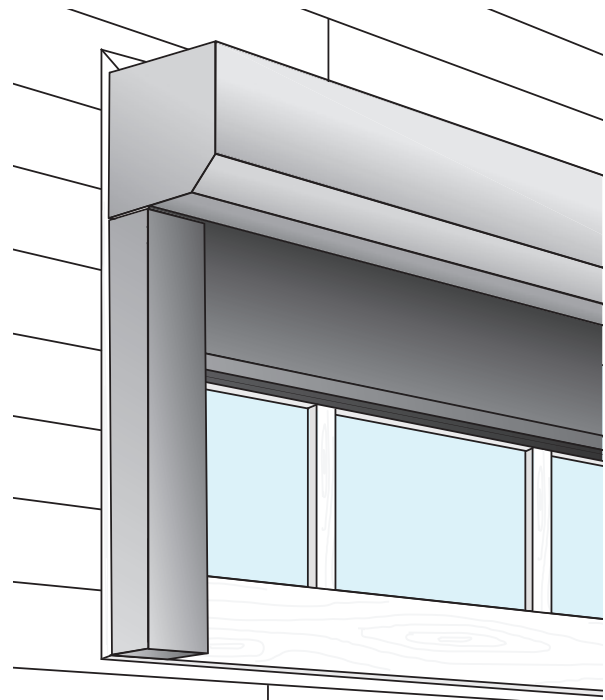
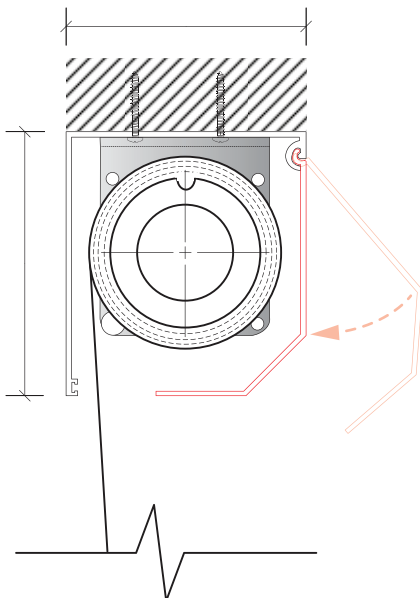

Exterior window application

Pocket Options

5" x 5 1/2" Extruded Pocket

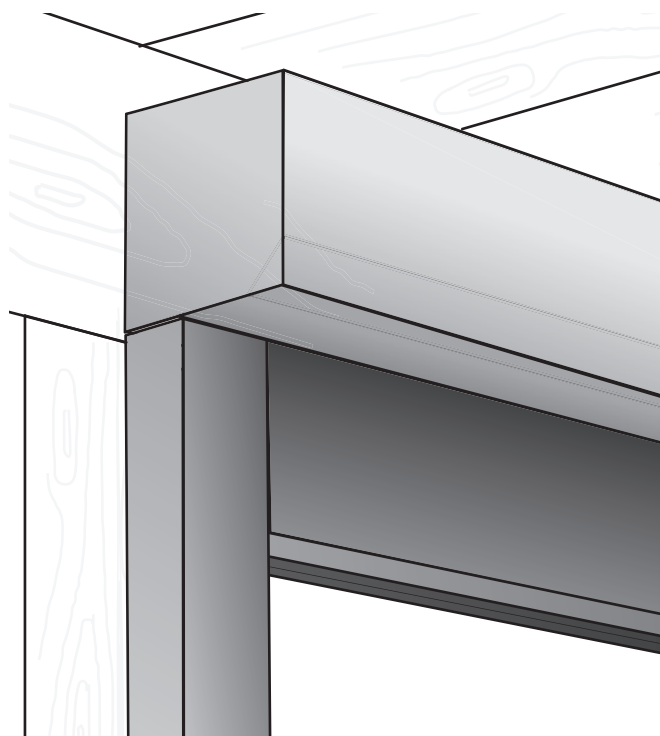

- 5" x 5 1/2" aluminum extruded shade pocket with access flap
- Shades require access from the bottom
- Shade hangs below aluminum pocket into side tracks 3 3/4" when retracted

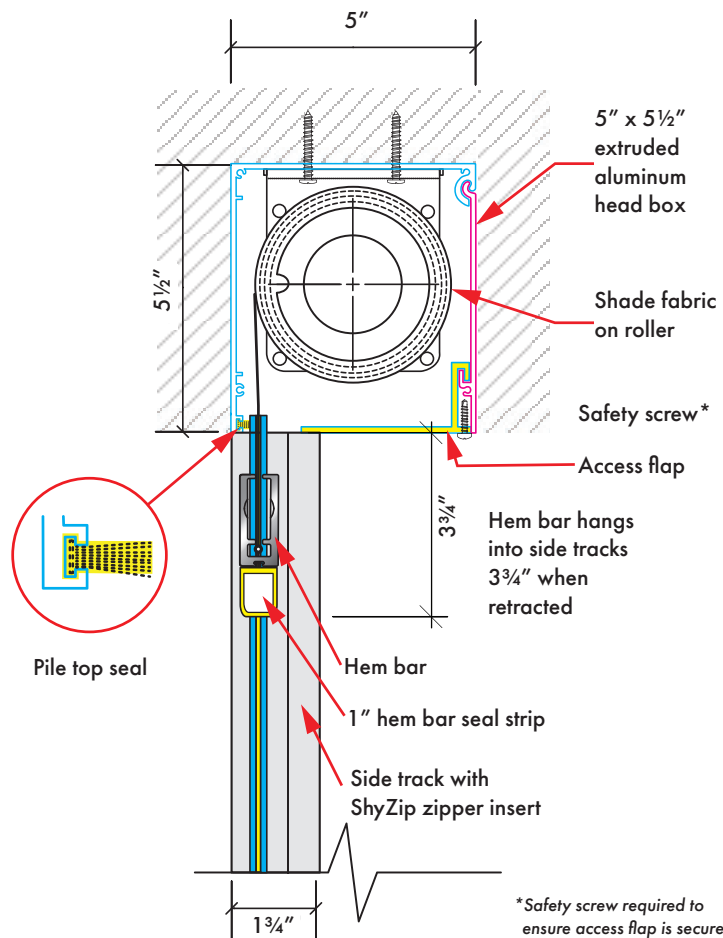
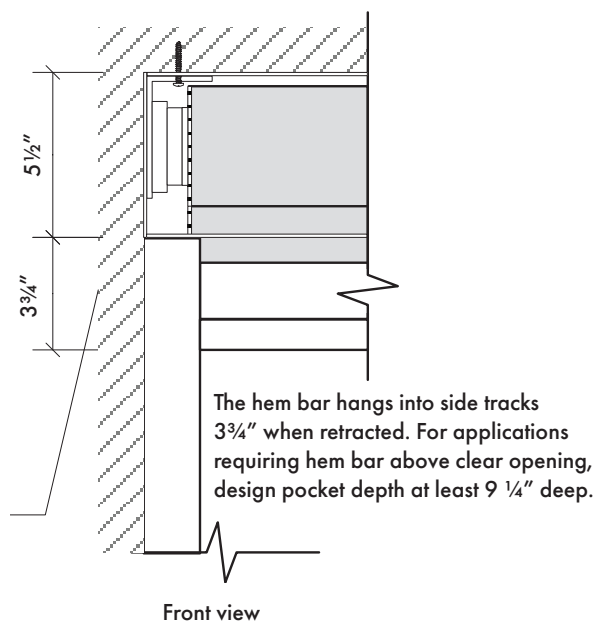

Site-built Pocket

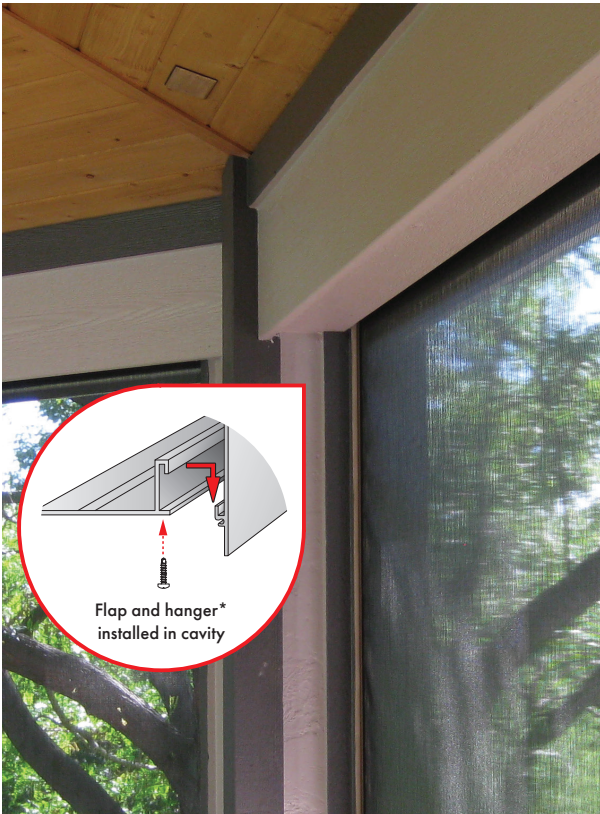

- Shown with recessed side tracks
- Shade access can be provided by removable access panel on bottom or front of pocket.*

*Shade access becomes more difficult with concealed side tracks and pocket application. Larger pocket depth is required to enable shade installation. There are many ways to detail shades into new construction. Please refer to Oasis 2900 New Construction Detailing Guide for more information (download at insolroll.com).

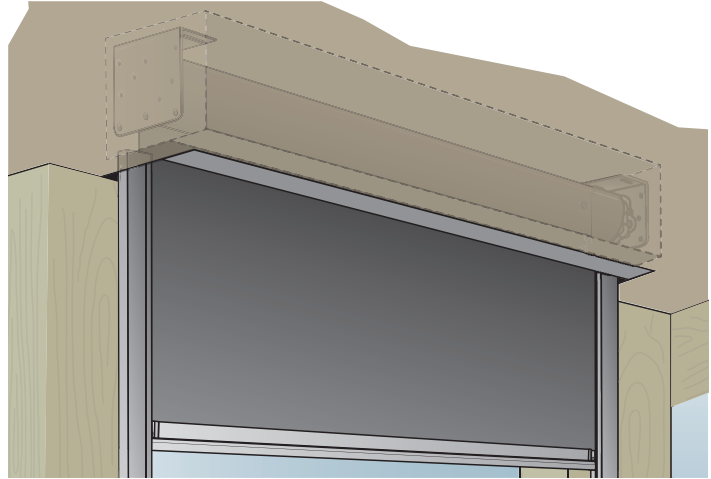

Custom site-built pocket with 5 1/2" x 5" clear opening

Universal Shade Brackets

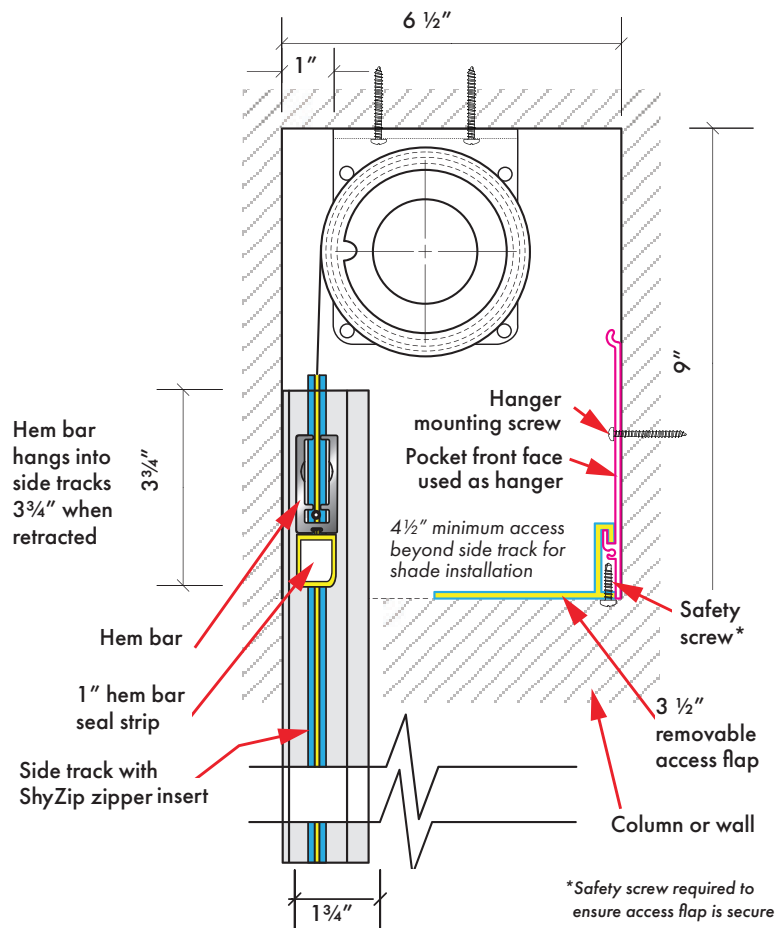
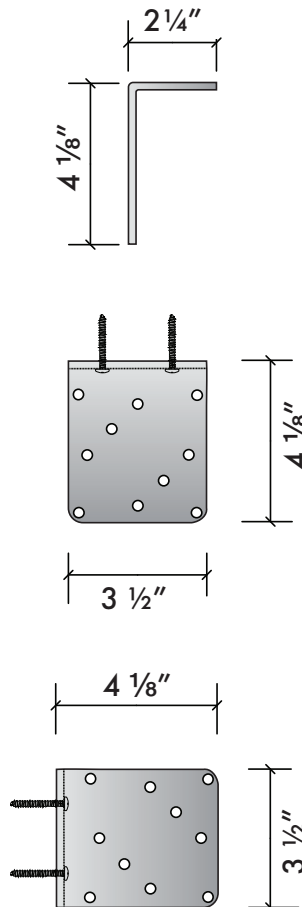

*Safety screw required to ensure access flap is secure

SHY® Zip Fabric Guide System

Zipper-captured Fabric System



2900 shade in site-built pocket with recessed side tracks



5" x 5 1/2" extruded aluminum head box

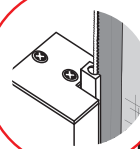

Side track with ShyZip insert

Weighted aluminum hem bar



1" hem bar seal strip flexes and compresses to seal uneven surfaces.

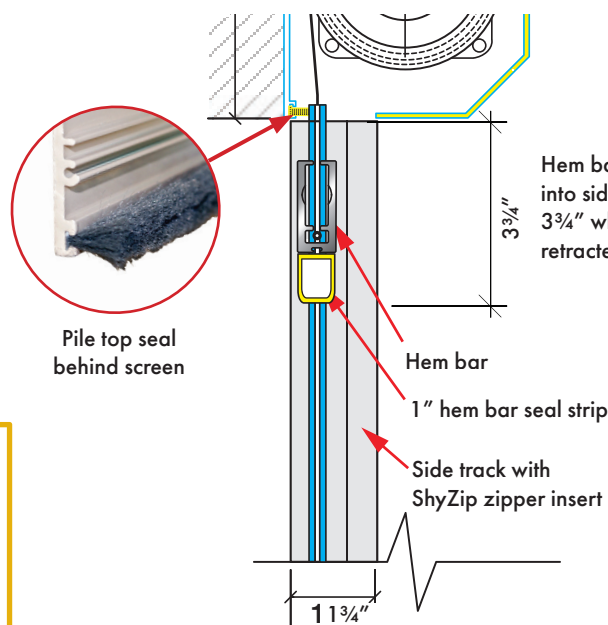

Pile top seal behind screen

Hem bar hangs into side tracks 3 3/4" when retracted

Hem bar

1" hem bar seal strip

Side track with ShyZip zipper insert

11 3/4"

Oasis 2900 Hardware colors

White

Bronze

Tan

All hardware options available with side track

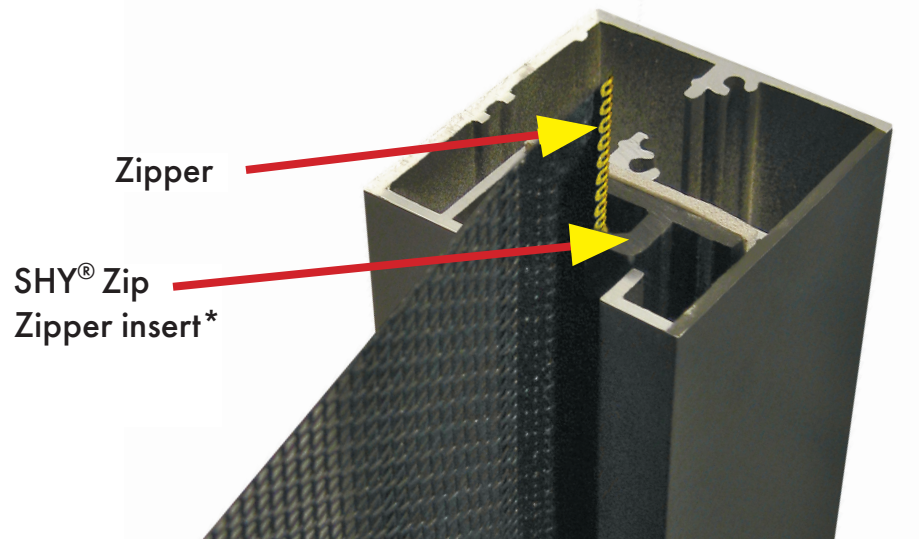

Side-mounted side tracks

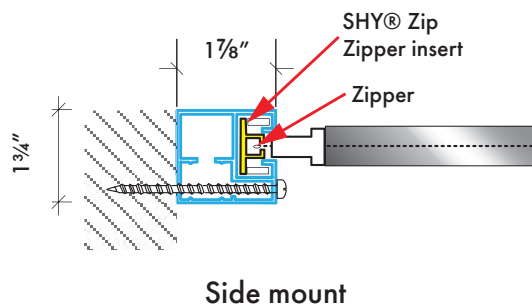

Side mount

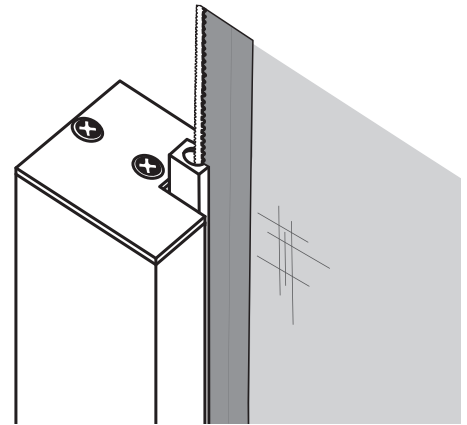

Side track with ShyZip zipper insert

Note: Side tracks pre-drilled for surface or face mount unless otherwise specified.



Face-mounted side tracks with matching plug buttons

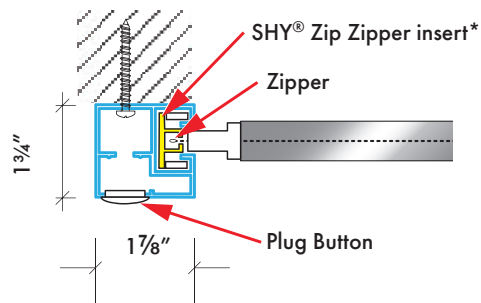

Face mount



Zipper-captured fabric edge in side track

Recessed Side Tracks in U-Track



U-Track with side track inserted leaves room for mounting screws.

- U-Track is $\frac{1}{2}$ " wider than side track
- When detailing U-Track with stucco, contractor may want to provide $\frac{1}{4}$ " reveal on U-Track to keep stucco out of U-Track channel
- U-Track can also be used as a solution for out-square-openings
- Please refer to *Oasis 2900 New Construction Detailing Guide* when using recessed side tracks with pocket applications. Access to install shade requires attention to detail! (download from insolroll.com)



U-Track installation sequence

1. Mount U-Track prior to masonry
2. Finish masonry to U-Track
3. Install Oasis 2900 side track at time of shade installation

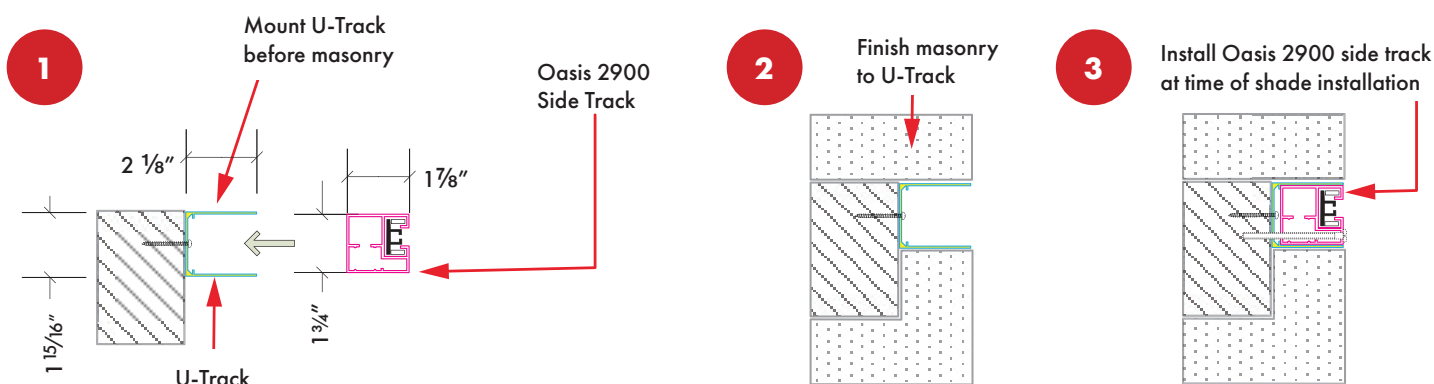
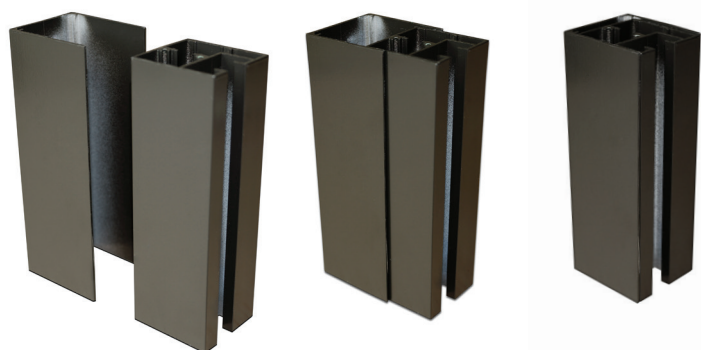



Somfy Radio Motor Control



Lutron Electronic Drive Unit

Somfy has been the international leader in motorization for outdoor shading systems for nearly 50 years. Insolroll's Quiet Radio Motor (IQM-ACR) is a 110 V AC motor utilizing a 6 N·m or 10 N·m Somfy motor depending upon shade size.

Additional Motor Options

- IQM-AC: 110V AC quiet bi-directional motor with 4-wire hardwire switch control
- IQM-485-AC: 110V AC power input and data cable connection to digital network. Ideal for large home automation and building control applications.

Our Technical Alliance with Lutron Electronics brings best-in-class motorized outdoor shading systems to the luxury home market. Lutron Roller 300 Electronic Drive Unit 3.5 V DC drive integrates seamlessly with Lutron Homeworks QS®, Radio RA2®, and Caséta® Controls.

Control Options

- Simple wireless switches and transmitters for stand-alone applications, RadioRA® 2 or Caséta® wireless lighting control systems
- Complete integration with Lutron HomeWorks®



Indoor wireless
Radio Wall Switch
(available with 1, 2,
3, 4, or 5 channels)



Outdoor radio
transmitter
(single-channel
or 5-channel)



MyLink wifi app
control for iOS,
Android, and
integration devices



RF Dongle
Radio Receiver



Pico® Wireless
Remote Control
Transmitter



Tabletop
pedestal for
Pico Remote