



Oasis® 2800 Patio Shade Installation Instructions

The Oasis® 2800 Patio Shade system is available in a complete head box, pocket head box or an exposed bracket option with two guide systems (sidetrack or cable guide) and two types of operators (crank and gear or motorized) . The pocket solution is not available with the manual crank operator. This document provides installation instructions for all shade systems.

Order height is defined as the distance from the top of the back cover to the bottom of the sidetrack or cable guide. Verify the window opening versus the shade order size before installation.

1. Tools

Screw gun with Phillips head bit extender; Hex head driver; Standard and Phillips head screwdriver; wire strippers/cutters; pliers or channel locks; level; AC motor test switch; tape measure; 3/16 inch drill bit; 3/8 inch drill bit.

2. Shipped components

The roller shade (tube, fabric, and motor or gear insert) rests in the back cover. The front cover rests in the back cover.

Depending on the application, the following components are included in the shipment: Left and right end plates, fully assembled idler bracket, fully assembled motor mount, fully assembled gear on gear bracket, hembar, sidetracks, plug buttons, grommet, cable guide components, and extra end plate screws.

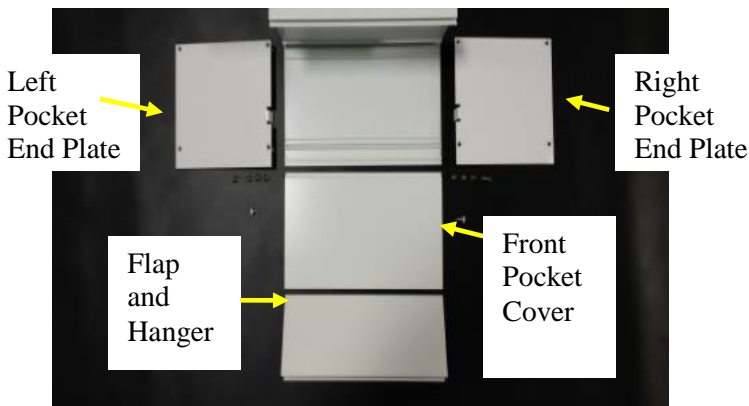
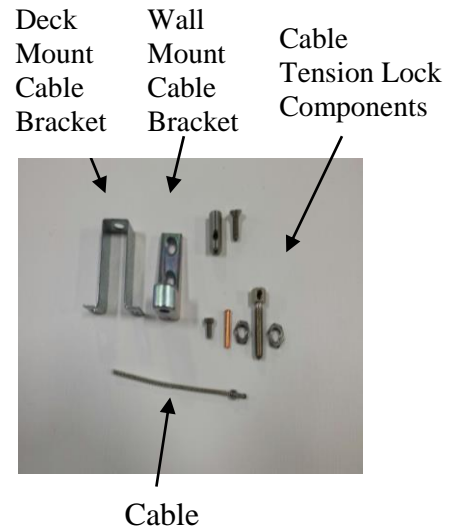
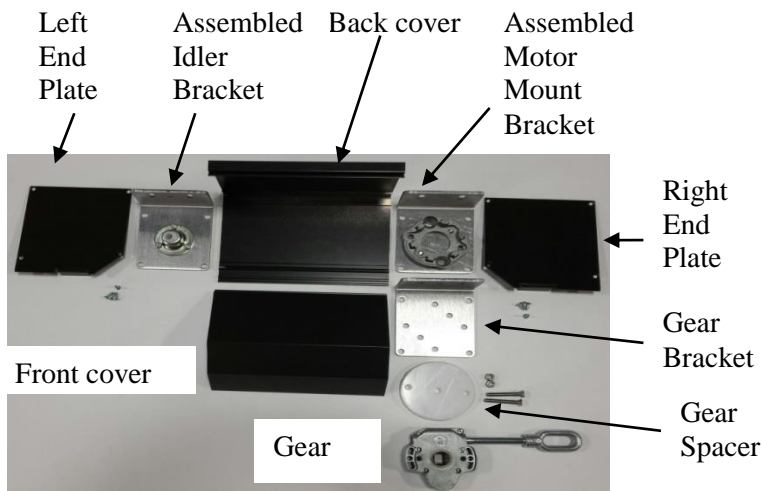



Oasis® 2800 Patio Shade Installation Instructions

Traditional Head Box

1. Assembly and Installation Instructions

A. Gear Assembly and Configurations (for manual crank gear application only)

Gear Components

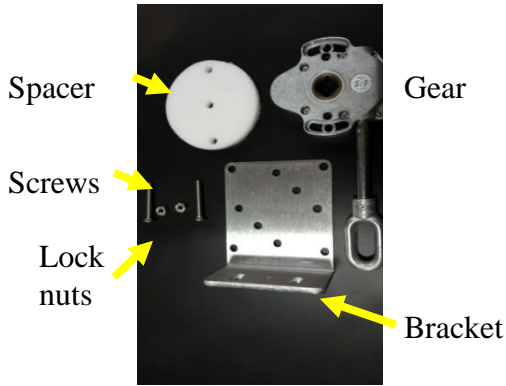

Assembled Gear Options

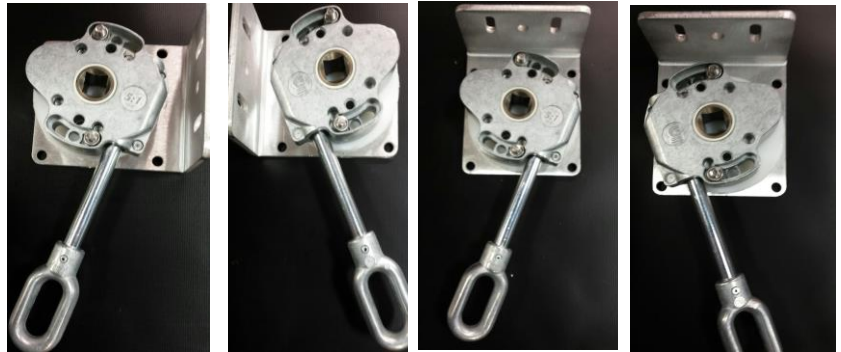

Left
Hand
Wall

Right
Hand
Wall

Left
Hand
Ceiling

Right
Hand
Ceiling

For a detailed explanation about changing the gear orientation, refer to the document named *Oasis Manual Gear Down Limit and Configuration Instructions* included in the product shipment.

To change the gear configuration, manually **loosen the retaining screws and lock nuts by hand, using a screwdriver**, not a screw gun. Orient the gear to the desired position, re-insert the retaining screws through the holes in the spacer and bracket, and **firmly secure the retaining screws and the lock nuts by hand, using a screwdriver**.

Insert the retaining screws into these two positions for wall mount.

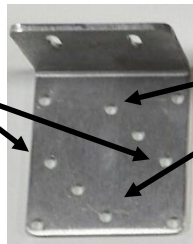

Insert the retaining screws into these two positions for ceiling mount.

For Cable Guide Application Only

Secure cable guide with the supplied screw. Feed the un-crimped end of the cable through the cable guide so the crimped end of the cable is above the cable guide. Repeat this process for the gear bracket.



Locations of the cable guide:

Right hand wall mount
Right hand ceiling mount

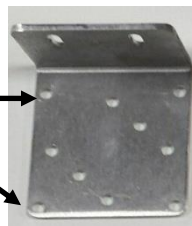

Left hand wall mount
Left hand ceiling mount



Oasis® 2800 Patio Shade Installation Instructions

B. End Plate Assembly

End plates are not attached to the back cover prior to shipment.

1. Align the end plate so the tangs are facing each other.
The tang faces toward the inside of the head box for the right end plate shown below.

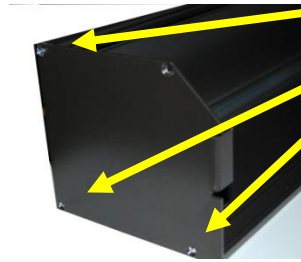
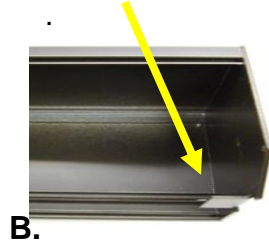

Carefully secure each end plate to the back cover with three painted, #6 by $\frac{3}{4}$ inch stainless steel sheet metal screws (supplied).

C. Bracket hole marking on back cover

Align the bracket in between the bracket location ridge in the back cover extrusion.

1. For ceiling mount, align the motor/gear bracket to the top of the back cover flush with the end plate. Mark the box. Repeat this alignment and marking process for the idler bracket. Pre-drill all the bracket holes with a $\frac{3}{16}$ inch drill bit.
2. For wall mount or outside mount, align the motor/gear bracket on the back of the back cover flush with the end plate. Mark the box. Repeat this alignment and marking process for the idler bracket. Pre-drill all bracket holes with a $\frac{3}{16}$ inch drill bit.

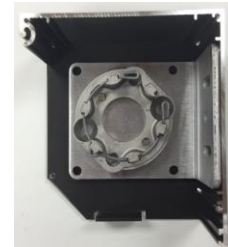
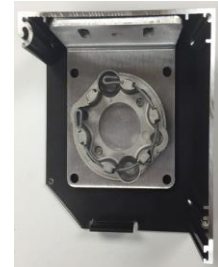

Mark and drill a hole either through the top or back of the back cover or the end plate for future routing of the motor wire. Use a $\frac{3}{8}$ inch or $\frac{1}{2}$ inch drill bit depending on diameter of wire. Use of a rubber grommet in the drilled hole is recommended to protect the motor wire.

The installation sequence of the back cover or the sidetrack is based on the application. Secure the end plates to the back cover before back cover installation.



Oasis® 2800 Patio Shade Installation Instructions

D. Back cover and bracket installation

The top of the back cover is mounted at the order height. Dry fit the sidetracks to ensure correct fit with the bottom of the back cover. Secure the back cover using intermediate mounting points spaced four to six feet apart. Pre-drill holes for easier installation.

Screw back cover to mounting surface using #8 x 1 ½ inch or longer pan-head screws (not provided). Ensure that the back cover is level. Be careful not to over-tighten screws as this may cause damage to the back cover.

Screw brackets to wall or ceiling mounting surface through the back cover with #10 x 1 ½ inch or longer pan-head screws (not provided).

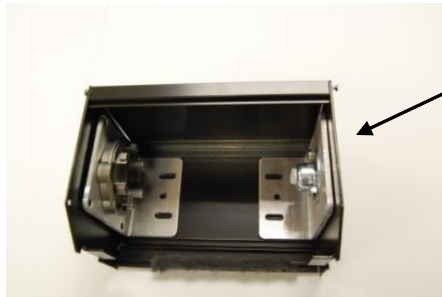

Wall mount with motor bracket in the left picture.



Ceiling mount with motor bracket in right picture

E. Side track installation



During the back cover installation, ensure that the end plate is flush to the outside edge of the sidetrack.

Mount sidetracks at appropriate opening width and height using a # 8 screw at least two inches in length (not provided). Ensure the sidetracks are plumb and parallel to each other

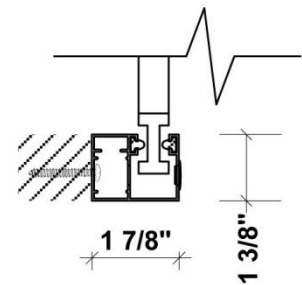

Side Track Detail

Side track can be installed as face mount or side mount



Oasis® 2800 Patio Shade Installation Instructions

F. Shade installation

1. Motor application

Remove motor retainer clip from motor mount. Install the shade into the head box by inserting the spring idler into the spring idler bracket, compressing the spring and inserting the motor drive into the motor drive bracket ensuring that the motor limits are accessible as required.

In the previously drilled hole, orient the power wire so it does not interfere with the shade operation. Ensure there is an adequate drip loop length so no condensation can travel to the motor head. Refer to the section named Important Notes for Electrician at the end of this document



Re-attach the motor retainer clip. Connect power to motor as required or use a test switch (not included), then run the shade down eight to twelve inches from the top. Refer to the programming instructions included with product shipment for AC and ACR motors.



Spring idler insertion



Securing motor retainer clip

2. Gear application

Install the shade into the head box by inserting the spring idler into the spring idler bracket, compressing the spring and inserting the crank drive end of the axle into the gear. Remove the plastic sleeve protecting the shade. Attach the crank handle to the gear eye. Using the crank, unroll about twelve inches of fabric from shade roll.

G. Hembar installation

1. Sidetrack



Insert hembar into the hem pocket at the bottom of the fabric. Hembar pop rivets face toward the back.



Tilt one end of the hembar, insert into sidetrack at the top, and let it drop down into the sidetrack.

Tilt the other end of the hembar, insert into sidetrack at the top, and let it drop down into the sidetrack.

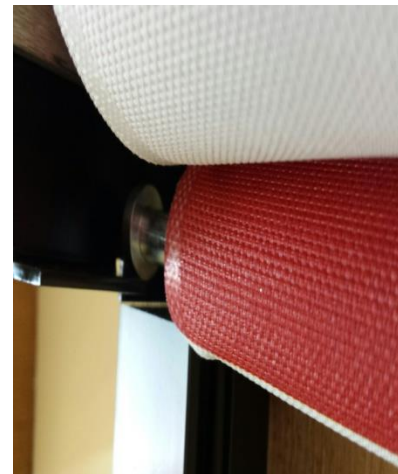



Oasis® 2800 Patio Shade Installation Instructions

2. Cable guide



Insert hembar into the hem pocket at the bottom of the fabric.

Hembar pop rivets face toward the back.

Slide cable through hembar cable guide inserts

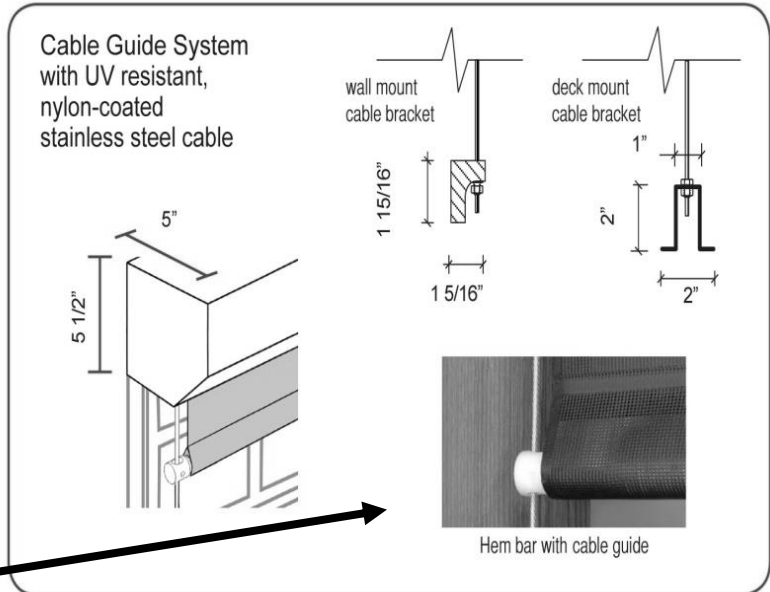



Oasis® 2800 Patio Shade Installation Instructions

H. Cable guide installation

Remove either wall mount or deck mount guide brackets from the plastic bag. Attach brackets to the wall or the deck at bottom of shade location. Vertically align the guide brackets with upper cable guide hole in the idler and gear bracket, respectively.

The wall mount angle bracket can be installed with the mounting leg facing up or down depending upon installation requirements.



Wall Mount

Deck Mount

Remove threaded cable lock assembly from plastic bag. Remove bottom nut and insert assembly into bracket hole. Re-attach nut onto assembly making sure the copper sleeve remains seated in top of the assembly.

Pull the cable taut beside the wall or deck mount bracket. Mark the cable approximately 2" above the copper sleeve, and Remove the sheathing off the cable with a 12-gauge wire stripper.

Insert the cable through the hole in cable lock assembly. Using a pair of pliers, pull cable taut and tighten 7 mm bolt on the cable tension lock. This screw must be completely tight to crush copper sleeve in cable lock.

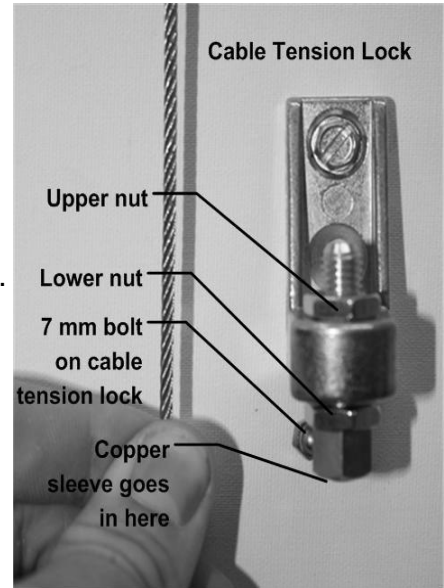

Loosen the upper nut and tighten the lower nut to adjust the cable tension. Do not over tighten. Re-tighten the upper nut. After tightening the cable, trim excess cable below cable lock with diagonal pliers (leave a minimum of 1" of cable exposed).





Oasis® 2800 Patio Shade Installation Instructions

I. Setting Limits

1. Motor

Refer to programming instructions included with the product shipment to finalize upper and lower travel limits.

2. Cranked gear (Down limit only)

Crank the shade to the desired down position.

Compress shade against idler side and completely remove square crank drive pin from the gear.

Continue cranking in downward direction until you cannot crank any further. While re-inserting the square crank drive pin into gear, rotate the shade as required to align the shade in desired position. Down stop is now set.

J. Final Adjustments

Operate shade up and down several times. Make any adjustments for telescoping or levelness of fabric. See included telescoping correction information if necessary.

K. Plug buttons

Insert plug buttons into sidetrack holes for face mount applications.



L. Front cover installation

Insert the front cover tongue into the back cover groove.

After correctly inserting the front cover in the groove, the front cover will stay engaged as it closes. Secure the end plate to the front cover with a #6 by 3/4 inch screw (supplied).

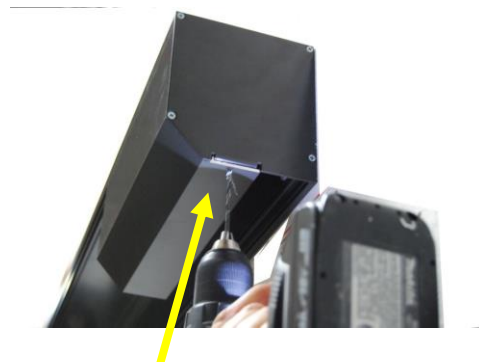

If outside mount end plate screw holes are not accessible, secure the front cover to the end plate tang.

Drill a hole in the front cover and through the end plate tang with a 1/8 inch bit then secure with a 3/8 inch painted sheet metal screw (supplied).

For wider shades, the two installers are positioned approximately 1/3 the distance from each end to ease the installation of the front cover.



Oasis® 2800 Patio Shade Installation Instructions

Pocket Head Box

1. Assembly and Installation Instructions

The pocket solution is not available with the manual crank operator. This document provides installation instructions for all shade systems.

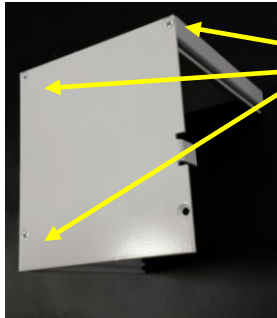

In most cases, the box is fully assembled before installation. Secure the end plates to the back cover using six #6 by 3/4 inch painted stainless steel self-tapping screws.

A. Bracket hole marking on back cover

Align the bracket in between the bracket location ridge in the back cover extrusion.

1. For ceiling mount, align the motor/gear bracket to the top of the back cover flush with the end plate. Mark the box. Repeat this alignment and marking process for the idler bracket. Pre-drill all the bracket holes with a $\frac{3}{16}$ inch drill bit.
2. For wall mount or outside mount, align the motor/gear bracket on the back of the back cover flush with the end plate. Mark the box. Repeat this alignment and marking process for the idler bracket. Pre-drill all bracket holes with a $\frac{3}{16}$ inch drill bit.

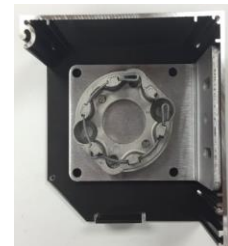

Mark and drill a hole either through the top or back of the back cover or the end plate for future routing of the motor wire. Use a $\frac{3}{8}$ inch or $\frac{1}{2}$ inch drill bit depending on diameter of wire. Use of a rubber grommet in the drilled hole is recommended to protect the motor wire.

The installation sequence of the back cover or the sidetrack is based on the application. Secure the end plates to the back cover before back cover installation.



Oasis® 2800 Patio Shade Installation Instructions

B. Front Cover Installation



Insert the front pocket cover tongue into the back cover groove. After correctly inserting the front pocket cover in the groove, the front pocket cover will stay engaged as it closes. Secure the front pocket cover with two #8 by 1/2 stainless steel self-tapping screws.



C. Hardware, Shade, Hembar, Cable Guide Installation

To complete the pocket head box installation, follow steps D through H for the Traditional Head Box as noted previously in this document. Ignore any references to the manual crank or gear.

D. Limit Set, Plug Buttons, and Final Adjustments

To complete the pocket head box installation, follow steps I through K for the Traditional Head Box as noted previously in this document.

E. Optional Flap Installation

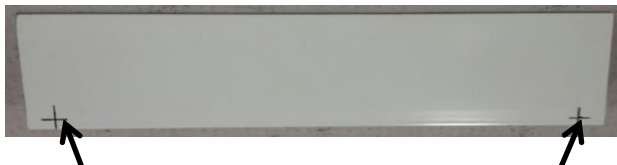

Mark a hole 1/2 inch from the left and right end of the flap and 1/4 inch from the back of the front pocket cover. Using a 1/8 inch drill bit, pre-drill a hole into the two marked locations on the flap. After securing the flap on the hanger, screw a #8 by 3/4 inch sheet metal screw (supplied) into the pre-drilled hole on each end of the flap.

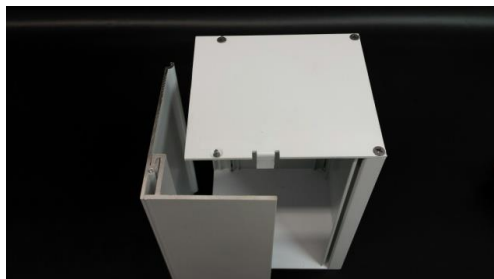



Oasis® 2800 Patio Shade Installation Instructions

Exposed Bracket

Sidetrack or Cable Guide System using Motor or Cranked Gear

1. Bracket mounting

For exposed roller applications, use the Insolroll universal shade mounting brackets.

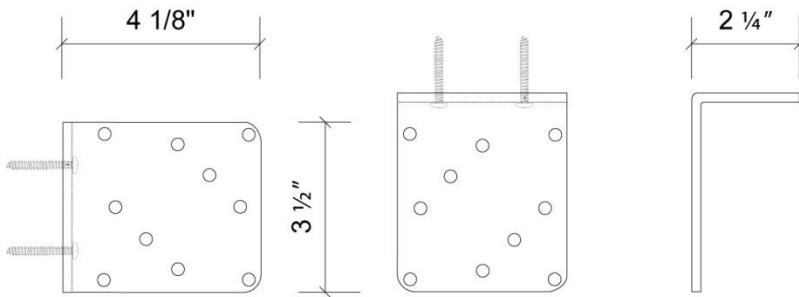

Universal Shade Mounting Brackets

Used with exposed roller or within headbox
(Wall or ceiling mount)

Based on the order width, mount the brackets (ceiling or wall). Ensure the bracket aligns with the sidetrack so the fabric drops straight into the sidetrack.

Exposed Roller

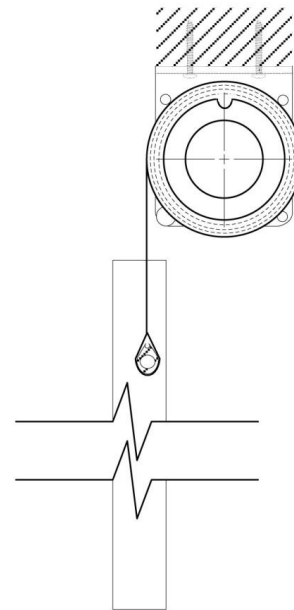

2. Installation instructions

For Gear and Sidetrack application, follow previously defined steps 3A, 3E,3F,3G,3I,3J,3K
For Gear and Cable application, follow previously defined steps 3A, 3F,3G,3H,3I,3J,3K
For Motor and Sidetrack application, follow previously defined steps 3E, 3F,3G,3I,3J,3K
For Motor and Cable application, follow previously defined steps 3F, 3G, 3H,3I,3J

Troubleshooting – Telescoping Shade Adjustment

1. To adjust shades for telescoping (excessive horizontal movement of fabric while shade rolls up on the tube), roll the shade all the way down so the tube is exposed (this will require adjustment of the down limit on motor).
2. Place a 4" piece of tape (2"-4" in from the end of shade) on the side of the tube opposite of the direction the fabric is moving.
3. Run the shade up. If shade still telescopes, repeat the process. The correct amount of tape can only be determined by trial and error.
4. Re-set the down limit after completing shade adjustments.



Oasis® 2800 Patio Shade Installation Instructions

Important Notes for the Electrician

1. An Underwriters Lab (UL) Listed cable clamp or cable gland must be used that is suitable for the diameter of the cable. The outside diameter of the motor cable is nominally 0.340 inches (8.64mm). This will ensure that the connection between the motor cable and the junction box is stable and reduces strain on the conductors.
2. Any switch, connector, and/or junction box should be UL Listed.
3. For motorized shades provided with a NEMA 5-15P plug cap, the plug cap must be inserted into a grounded receptacle. “To reduce the risk of electrical shock, this equipment has a grounding type plug that has a third (grounding) pin. This plug will only fit into a grounding type outlet. If the plug does not fit into the outlet, contact a qualified electrician to install the proper outlet. Do not change the plug in any way.”
4. Any electrical wiring that is designed to be permanent shall be employed as required by local codes.
5. Ensure there is adequate drip loop length so no condensation can travel to the motor head. An example of a drip loop is shown below:



Insolroll has been granted a UL Listing for complete motorized shade systems including any of six upgraded motors (Model #s STD-AC, STD-ACR, STD-AC-ILT, IQM-AC, IQM-ACR, and IQM-AC-ILT).