

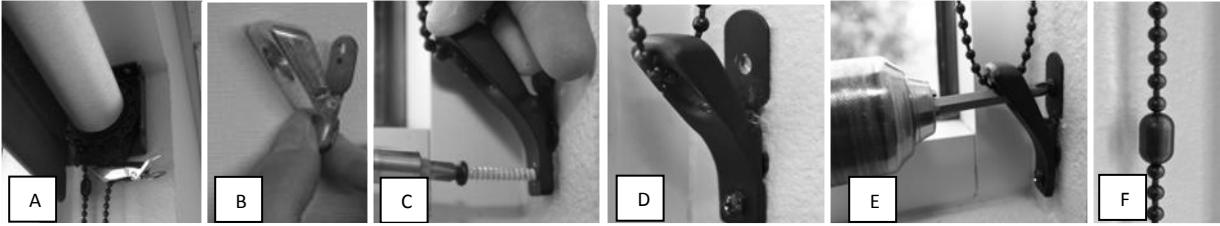

# Installation Instructions for Insolroll® Metal Select Chain Guide

*Metal Select Chain Guide is a chain tension device designed for inside or outside mounts.*



1. Shades come with chain guide attached to shade in a manner that installer must release and install this chain tension device for the shade to be fully operational. (Fig. A)
2. After mounting shade in brackets, squeeze on flanges furthest from the chain to open, this releases tension on chain guide to slide it down to the bottom of the chain loop. (Fig. B)
3. Open the chain guide prior to screwing to wall or window frame by squeezing flanges open or using your finger to hold open while **attaching bottom screw first**. (Fig. B, C, D) If chain guide is not opened before attaching to wall, or top screw attached first, **chain will over-tighten** and may make shade operation rough. #8 self-tapping mounting screws (provided) are designed for installation in wood trim, drywall, or aluminum mullion. See typical mounting conditions below.
4. Operate shade after bottom screw is attached to ensure smooth operation. Use a 3 ½" extended screw bit to ensure the bit does not catch on the chain; attach the top screw through the chain guide opening. (Fig. E)
5. Attach chain stops for upper and lower limits of the shade. (Fig. F)

## Typical Mounting Conditions

Wood Trim or Jamb	Drywall with Stud Behind	Drywall with No Stud Behind	Hollow Aluminum Mullion
<p>Screw directly into wood trim or jamb. For hardwood trim, pre-drill a 1/16" hole to avoid splitting trim. For applications with metal stud behind, it may be necessary to pre-drill depending upon gauge of stud.</p>	<p>Screw directly into drywall with wood or metal stud behind it. For applications with metal stud behind, it may be necessary to pre-drill depending upon gauge of stud.</p>	<p>Place chain guide at desired location. Mark location for screw anchors. Remove chain guide. Punch hole in drywall and attach anchor to drywall. Screw self-drilling anchor into drywall (Nylon Zip-It wallboard anchor or equal). Place Metal Select chain guide back into position and mount chain guide with screws into drywall anchors. <i>(Drywall anchor NOT SUPPLIED.)</i></p>	<p>Place chain at desired location. Mark location for screws and pre-drill a 1/16" hole. Move chain guide back into position and screw into window mullion.</p>

### ⚠️ WARNING

The cords on this product present a potential strangulation hazard.

For child safety, consider cordless alternatives or products with inaccessible cords.



### ⚠️ ADVERTENCIA

Los cordones de este producto representan un peligro potencial de estrangulamiento.

Para la seguridad de los niños, utilice alternativas sin cordón o productos cuyos cordones sean inaccesibles.

For more assistance, contact Insolroll, Inc.  
[www.insolroll.com](http://www.insolroll.com) 800-447-5534 Rev 6/13