



Insolroll
WINDOW SHADING SYSTEMS

*Block the Sun,
Not the View*



OASIS[®] Exterior Solar
Screen Shades

Solar &
Insect
Protection
for Patios
& Windows



www.insolroll.com

2600

Oasis® 2600 Sun Shades

Exterior Clutch-operated Solar Screen Shade designed for patio applications

- Heavy duty brackets
- Exterior grade clutch & bead chain
- Bungee cord hold-downs
- All fabric edges welded

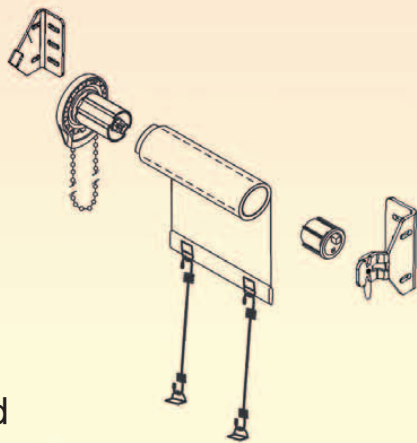

2700

Oasis® 2700 Exterior Window Shades

Exterior Solar Screen Shade designed for window applications

- Reinforced cast-aluminum brackets
- Aluminum head box
- All fabric edges welded
- Available with *interior* crank or motorized operation
- Heavy-duty side track or cable system*

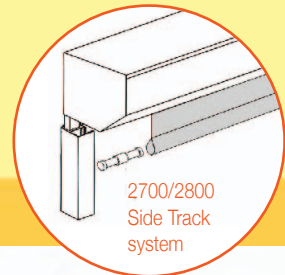
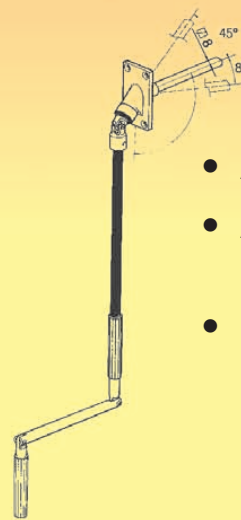

2800

Oasis® 2800 Patio Shades

Exterior Solar Screen Shade designed for patio applications

- Reinforced cast-aluminum brackets
- Aluminum head box
- Heavy-duty side track or cable system
- All fabric edges welded
 - Available with *exterior* crank or motorized operation
 - Heavy-duty side track or cable system*

*2700/2800
Choice of
track or cable
guide system
to secure
fabric

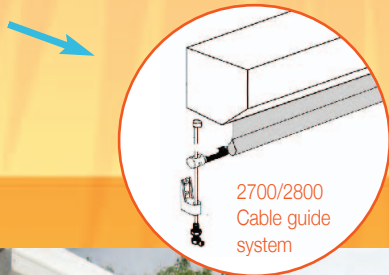

2900

Oasis® 2900 Solar Insect Shades

Solar Insect Shade designed for window, door, patio or garage applications

- Minimizes fabric movement due to wind and outdoor elements
- Prevents insect intrusion
- Decreases solar heat and glare

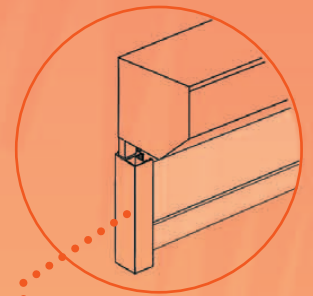

Insolroll uses the time proven SHY Zip technology to seal the edges of the shade. SHY Zip is a product of SHY Co. Ltd. of Japan and distributed exclusively in North America by its authorized sub-licensees.

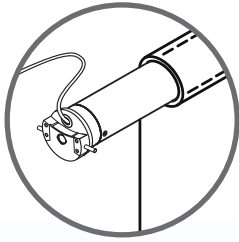

110 volt AC tubular motor or crank and gear operator

Fully enclosed aluminum head box protects fabric when retracted; available in white, bronze and tan.



Insolroll's specialized fabrics for exterior solar screen shades range from 1% to 14% openness to control varying degrees of sun exposure.

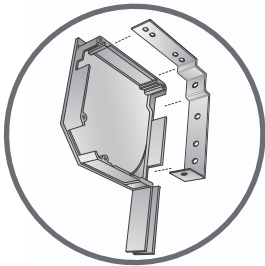

Reinforced bracket design for large patio installations

Reinforced, welded edges provide increased fabric durability

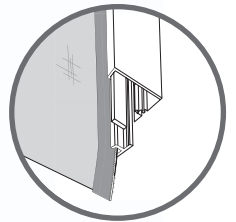

2900 Solar Insect Shade Side Track

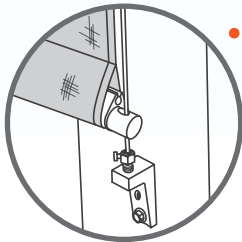

2700/2800 Cable Guide & Hem Bar

Wall mounted cable guide system featuring UV-resistant vinyl-coated stainless steel aircraft cable shown above. Deck mount bracket available.

2700/2800 choice of track or cable guide system to secure fabric

2700/2800 Track Guide

Aluminum side channel with vinyl insert to increase durability; available in white, bronze and tan.

Exterior Head Box Finish Options



White



Bronze



Tan



637 S. Pierce Ave.
Louisville, CO 80027

tel 800.447.5534
fax 303.665.1209

www.insolroll.com
info@insolroll.com